

May 2023 Newsletter

From The Executive Director

"I believe we are here on the planet Earth to live, grow up and do what we can to make this world a better place for all people to enjoy freedom."

~Rosa Parks



Natalie Lunt / EyeEm / Getty Images stock

**Freedom is the power or right to act, speak, or think,
as one wants without hindrance or restraint.**

We value the right to be who we want to be, whether others approve of not. We want to be able to choose what we wear, where we live, and how we support ourselves.

**We don't want anyone to dictate our career choice, our tastes,
or how far we can go in this world.**

**It is our obligation to preserve that freedom for each other,
regardless of how the other chooses to color or flavor their world.**

Constitutional rights are the protections and liberties guaranteed to the people by the U.S. Constitution. Many of these rights are outlined in the Bill of Rights; such as the right to free speech in the First Amendment, and the right to a speedy and public trial in the Sixth Amendment.

Human rights include the right to life and liberty, freedom from slavery and torture, freedom of opinion and expression, the right to work and education, and many more.

Everyone is entitled to these rights, without discrimination.

WCEDP EVENTS

Breakfast will
be provided by
Cornerstone
Cafe

2023 CAPACITY BUILDING SEMINAR

Dr. King Banaian

Dean of the School of Public Affairs at St. Cloud State University



20 years ago Minnesota economic development planners talked often of ‘the corridor’ between Minneapolis and St. Cloud as the next hot area for economic growth.

A housing boom, a financial crisis, and a pandemic later, where are we in the development of Wright (and Sherburne) counties in industry and people? We’ll get a view from the St. Cloud end of the corridor with Dr. King Banaian professor in the Department of Economics and dean of the School of Public Affairs at St. Cloud State University.

- What:** Wright County Economic Trends
When: May 24th, 2023 - 8:00 - 9:30am
Where: Wright County Government Center
Cost: **FREE - WITH BREAKFAST PROVIDED**
Register: <https://wrightpartnership.org/events>



REGISTER NOW

WCEDP EVENTS

JUNE 14, 2023
11 PM - 2 PM

Wright County Government Center
3650 Braddock Ave NE
Buffalo, MN 55313



**Welcoming
Wednesdays**
for Startups and Small Businesses
Make Connections. Get Answers.

Mini Presentations

Coleen Landkamer, USDA Rural Development
Josh Laffen, MN Business Financial Corporation
Joe Kammermeier, MN Business Financial Corporation
Marshall Hogenson, SCORE
Women Venture - TBD



**Lunch will be
provided!**
**RSVP by: June 7,
2023**

REGISTER NOW

WCEDP Partner EVENTS

HOW DO YOU HANDLE HR ISSUES IN TODAY'S WORKPLACE?

Human Resource Administrative Cooperative

Innovate
Collaborate
Share Best Practices
New Ideas that Work
Validate Ideas
Leadership Training
Meet Your Peers
Learn New Skills
Comparative Analysis
Brainstorm



**Join us for lively discussions on
HR topics important to you.**

For information, contact:

Tim Zipoy
763.271.3722
tzipoy@cmjts.org

Tim Zipoy -
tzipoy@cmjts.org

Sponsored by



Health Insurance

Worker's Comp

Veterans Returning to Work

Employment Law

Employee Training

Compensation

Motivation/Retention

Generational Trends

**Free monthly meeting, the second Thursday, 8:00 a.m.,
at the Monticello WorkForce Center**

WCEDP Partner EVENTS

Please Join Us!

**Professional Leaders, Managers, and
Professional Contributors in Job Transition**



**TUESDAYS
10:00–noon
CDT**

*A complimentary program provided exclusively by
Central Minnesota Jobs and Training Services, Inc. and CareerForce Monticello*

**Two full hours of developing strategies and tactics for professional job
transition, network expansion, and support for leaders, executives,
and professional individual contributors in job search mode.**

To learn more and **PRE-REGISTER** for our next meeting, go to:
<https://tinyurl.com/rbtzsw3>

Our facilitators:



Rob Stark

Partnering with People to
Achieve Their Financial Goals



Tim Zipoy

Business Service Coordinator
Central Minnesota Jobs and
Training Services, Inc.



KimAileen White, MA

Assisting Individuals through
Transition since 1990



CMJTS

Central Minnesota Jobs and Training Services, Inc.



Equal Opportunity Employer and Program Provider

*Upon request the information in this document can be made available in
alternative formats for people with disabilities by calling 800-284-7425.*

Serving Chisago • Isanti • Kanabec • Kandiyohi • McLeod • Meeker • Mille Lacs • Pine • Renville • Sherburne • Wright Counties

Central Minnesota Jobs and Training Services, Inc.

406 East 7th Street, Suite 100, P.O. Box 720, Monticello, MN 55362 • 763.271.3700 • 800.284.7425 • www.cmjts.org

A proud partner of the *americanjobcenter* network | CareerForce

REGISTER NOW

WCEDP Partner EVENTS

WRIGHT TECH **CEO** 

CREATING ENTREPRENEURIAL
OPPORTUNITIES

You are invited to attend

Wright Tech CEO Business Expo

*Come and enjoy the creativity
as local high school entrepreneurs
present their businesses to the
public for the first time.*

Wednesday, May 24th

4:00 PM - 6:00 PM

Wright County Government Center

3650 Braddock Ave NE Room 1101

Buffalo, MN 55313

Open to the public

WCEDP Partner EVENTS

ClearValley

BUSINESS CONNECTIONS

EXPLORE CLEARWATER/ CLEAR LAKE

BUSINESS EXPO!

Sunday, May 7th • 10 am - 1 pm

Clearwater American Legion

Legion will be serving a made-to-order breakfast

Raffles!
Prizes!



Contact Lori Johnson to be a part of the event
at lori.rootofwellness@yahoo.com

Stop and check out the local businesses and organizations in the Clearwater/ Clear Lake area & enjoy breakfast thanks to the Clearwater American Legion!

ANNOUNCEMENTS



DEED Looking to Connect Homes, Businesses with Slow Internet Speeds

The Minnesota Department of Employment and Economic Development (DEED) is encouraging Minnesotans to apply for its Line Extension Program to connect homes and businesses to high-speed broadband.

Residents and businesses that don't have broadband speeds of at least 25 megabits per second download and 3 megabits per second upload can apply online through the Office of Broadband Development.

To take a speed test on your devices to determine your download and upload speed, click here: <https://www.speedtest.net/result/14638478423>

[READ MORE](#)

The new place to live in Minnesota? Wright County

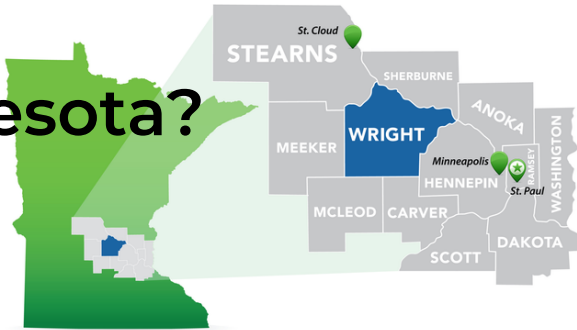

The population of central Minnesota's Wright County has grown by more than 4 percent since 2020, making it the state's fastest growing county according to new estimates released by the U.S. Census Bureau Thursday.

The Bureau's new data shows that the state's population overall is barely budging, growing by 0.1 percent over the past two years. That comes from a balance of population growth in 49 of the state's 87 counties and population loss in the remaining 38. Like the state as a whole, estimated population changes are relatively small, plus or minus less than 1 percent, in 45 counties.

[READ MORE](#)

ANNOUNCEMENTS CONT.



Wright Technical Center Celebrates 50 Years!



Many people visited Wright Technical Center (WTC) on Monday, April 17, for their open house in celebration of providing education to our community for 50 years. The open house was held from 4:00 to 7:00 p.m. (Photos by Dana Watters)

Wright Technical Center (WTC), located in Buffalo at 1405 3rd Avenue NE, recently celebrated serving the community for 50 years on Monday, April 17. The WTC is a cooperative public high school that provides instruction in career, technical, and alternative education. To celebrate 50 years, WTC held an open house. Tours were offered, hotdogs, hamburgers, and slices of cake were served, and there were door prizes. WTC serves eight school districts in Wright and Sherburne counties including: Annandale, Big Lake, Buffalo-Hanover-Montrose, Delano, Howard Lake-Waverly-Winsted, Maple Lake, Monticello, and St. Michael-Albertville.

The Mission of the Wright Technical Center is: "To partner with member school districts and industry to prepare students for careers, post-secondary education, and life-long learning." Career and technical programs offered at WTC include automotive technology, cosmetology, health science technology, welding technology, CEO-creating entrepreneurial opportunities, early childhood and elementary careers, law enforcement, construction technology, graphic communications, and on-the-job training.

ANNOUNCEMENTS CONT.



BANK OWNED COMMERCIAL LAND

\$4.44/SF - POTENTIAL HOTEL, OFFICE, AND APARTMENT SITES

PROPOSED DEVELOPMENT **POTENTIAL**

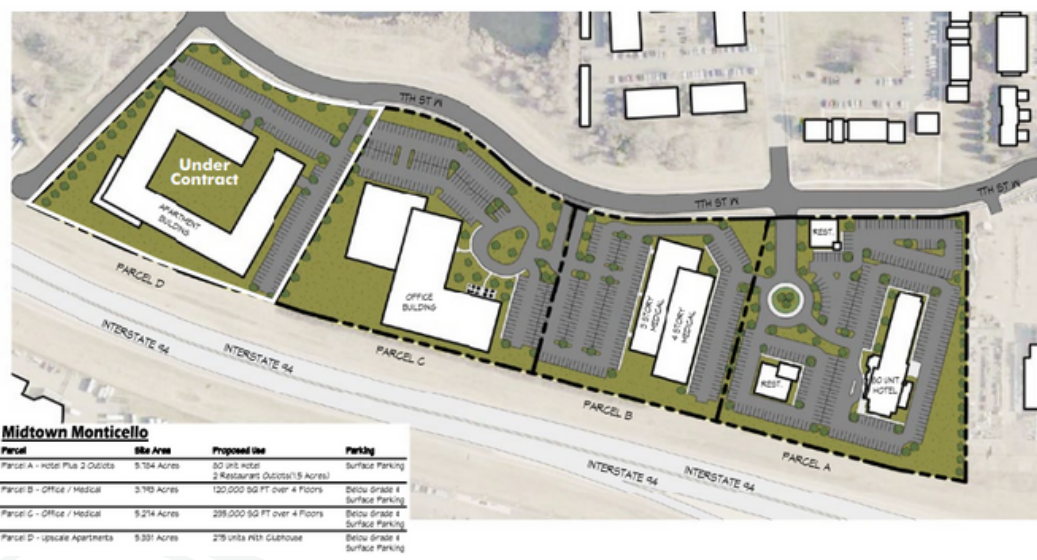

PROPERTY HIGHLIGHTS

- Price: \$4.44/SF
- City utilities to site (water, sewer, and storm sewer)
- PID 155-226-000020
- ±15 acres available
- Zoned B-3 (Highway Business District)
- Guided Commercial Residential Flex
- Easy access to I-94
- 2,100' of I-94 frontage
- 3.5 miles to Xcel Power Plant
- 1 mile to Mississippi River Bridge



READ MORE